

YOUNGSUN®

Stock code : 603901

Unmanned packing, Intelligent system



Youngsun Pack Group as a listed manufacturer for packaging machines and materials has influence on market. With 2600 employees and 36years professional experiences the machines are sold worldwide. As a drafting unit of national standard, Youngsun involves 8 industries.

- 1.Traditional packing machines
- 2.Packing materials
- 3.Packing solution for food and dairy industry
- 4.Packing solution for beverage industry
- 5.Packing solution for pharmaceuticals industry
- 6.Packing solution for chemical industry
- 7.Packing solution for cosmetic industry
- 8.Software for smart factories



Contents

YSDXR Serial Automatic Plastic Cup Forming, Filling and Sealing Machine	01-02
YSZB Serial Automatic Plastic Cup Filling and Sealing Machine	03-04
YSCSP10000 Ultra Clean Filling Capping Machine	05-06
YSYGF Automatic Rotary Plastic Bottle Filling and Sealing Machine	07-08
YLP Bottle Unscrambler	09-10
YXG Series Automatic Rotary Capping Machine	11-12
YOUNGSUN Cap Maker	13
CGX722 Blowing, Filling and Capping Combiblock	14
YSJ Serial Spray Type Pasteurization Tunnel	15-16
YSXZB Serial Automatic Rotary Preformed Cup Filling and Sealing Machine	17-18
YSXZL Serial Pouch Filling and Capping Machine	19-20
YOUNGSUN Spout Inserter	21-22
Secondary Packaging System	23
Service and Support	24



YSDXR Serial Automatic Plastic Cup Forming, Filling and Sealing Machine

YSDXR Series automatic plastic cup forming, filling and sealing machine offers a competitive forming, filling and sealing solution for liquid, semi-liquid and pasty food products, such as yogurt, milk, mineral water, beverage, ice cream, seasoning and so on.

The process is from ionization dedust remove, preheating, cup forming and labeling, dynamic fruit mixing and filling, cover sealing, date printing, cutting and product conveying. The cutting mould could be adjusted based on product requirement to form six-pack cups, eight-pack cups, twelve-pack cups.

YSDXR Serial machine will be equipped with the laminar flowing air purify system, CIP connection and volumetric dynamic fruit mixing system, it is full-automatic equipment for high-efficiency, high-quality production in modern enterprise. The machine can be customized according to customers' requirements so as to meet different customers' needs.

Applicable Filling material: Liquid: yogurt, milk, mineral water, beverage, ice cream, seasoning and so on
 Cap film material: Al+plastic laminated film; paper+plastic laminated film
 Forming film material: PS/PP/PET etc.

Main Technical Data:

Model	YSDXR-12000	YSDXR-20000	YSDXR-40000
Step cups	12	12	24
Standard capacity	10000 cups/h (100g)	20000 cups/h (100g)	36000 cups/h (100g)
Filling volume	50g-150g	50g-150g	50g-150g
Cup diameter	63mm x 63mm or 70mm x 70mm (can be customized)		
Forming film thickness:	0.8 mm -1mm	0.8 mm -1mm	0.8 mm -1mm
Air pressure	≥0.6MPa	≥0.6MPa	
Outer dimensions(appr.)	9.6×3.5×3.8m(L×W×H) (according to the machine options)		
Power supply (optional)	3N-PN-50Hz 380V/220V (3P 5 wires)		

* According to different characteristics of products, the capacity will be different.

Main Configuration:

Servo motor	Siemens
Cylinder:	SMC/ Festo
Reducer box:	SEW
Sensor:	P+F
Electromagnetic clutch	Yanxin
Touch screen:	Siemens
PLC:	Siemens
Inverter:	Schneider, Danfoss
Cylinder inspecting sensor	SMC
Position inspecting sensor	P+F
All low voltage electrical	Schneider, Siemens
Warning light	Schneider
Liquid level inspecting	E+H
Pneumatic butterfly valve	GEA

* Parameters and functions are subject to change without further notice.

Optional Function:

1. Fruit grain mixing filling
2. Code printer, ink-jet printing
3. Conveyors
4. Can be equipped with automatic packaging line.

Machine Structure:

- Conveyor system
- Electrostatic dust removal system
- Filling system
- Films convey system
- Cooling system
- CIP cleaning nozzle
- Electric controlling system
- Preheating system
- Forming system
- Wrap-Around labeling system(optional)
- Sealing system
- Cutting system
- Central lubrication system
- Dynamic fruit grain mixture filling system

Some Samples:





YSZB Serial Automatic Plastic Cup Filling and Sealing Machine

YSZB Series automatic plastic cup filling and sealing machine is capable of working under full-automatic conditions. The process is from cup loading, cup falling, filling, lid foil feeding and sealing, date printing and product output and liquid controlling. The filling and sealing machine can be customized to meet different customers' needs. The machine has been widely used in the food industry, packaging of the yogurt, milk, mineral water, beverage, ice cream, seasoning and so on.

Applicable Filling material: Liquid: Yogurt, milk, sauce and so on
 Cap film material: Al+plastic laminated film; paper+plastic laminated film, 0.08mm-0.15mm

Main Technical Data:

Model	YSZB-9000	YSZB-20000
Step cups	6	16
Standard capacity	9000 cups/h (150g)	20000 cups/h (150g)
Filling volume	50g-350g	50g-350g
Cup diameter	φ50mm~φ80mm	φ50mm~φ80mm
Cup height	25-140mm	25-140mm
Cap film	Sheet/Roll	Sheet/Roll
Total power	8KW	13.5KW
Air pressure	≥0.6MPa	≥0.6MPa
Air consumption	≥0.8m³/min	≥0.8m³/min
Outer dimensions(appr.)	4.8×2.3×2.6m(L×W×H)	8.8×2.8×2.6m(L×W×H)
Weight(appr.)	4200Kg	6200Kg
Power supply (optional)	3N-PN-50Hz 380V/220V (3P 5 wires)	

* According to different characteristics of products, the capacity will be different.

Main Configuration:

Servo motor	Siemens
Cylinder:	SMC/ Festo
Reducer box:	SEW
Sensor:	P+F
Electromagnetic clutch:	Yanxin
Touch screen:	Siemens
PLC:	Siemens
Inverter:	Schneider, Danfoss
Cylinder inspecting sensor	SMC
Position inspecting sensor	P+F
All low voltage electrical	Schneider, Siemens
Warning light	Schneider
Central lubrication system	BIJUR
Ultraviolet germicidal lamp	Heraeus

* Parameters and functions are subject to change without further notice.



Optional Function:

1. Servo driving filling
2. Class 100 laminar flow hood
3. Heraeus sterilizing module
4. Fruit grain mixing filling
5. Common high temperature sterilization module
6. Code printer, ink-jet printing
7. Conveyors
8. Can be equipped with automatic packaging line.

Machine Structure:

- Conveyor system
- Cup falling system
- Inside cup sterilization system (optional)
- Cap film adding system
- Sealing system
- CIP cleaning nozzle
- Automatic feeding cup system
- No cup detecting system
- Filling system
- Cap sterilization system (optional)
- Cup output system
- Central lubrication system

Some Samples:





YSCSP10000 Ultra Clean Filling Capping Machine

YSCSP10000 ultra clean filling capping machine is designed for plastic bottle filling and capping with high hygienic standard. It is consisted of bottle feeding, bottle picking and transportation, vaporized hydrogen peroxide sterilization and aseptic air drying, filling and capping, output systems and transport.

Applicable Filling material: Liquid: Yogurt, milk, drink, fruit juice and so on.
Applicable packaging material: HDPE/PP/PS/PET bottle.

Main Technical Data:

- Production capacity: 12000 bottles/h
- Power supply: 22.5Kw
- Filling heads: 12
- Air pressure: $\geq 0.6\text{MPa}$
- Filling volume: 100~700ml
- Machine weight: 6.2tons

* According to different characteristics of products, the capacity will be different.

Main Configuration:

Servo motor:	Germany Siemens
Sensor:	Germany P+F
PLC:	Germany Siemens
Inverter:	France Schneider
Temperature:	Japan Omron



Machine Features:

- Online vaporized H_2O_2 concentration monitoring and makes sure the sterilization.
- Vaporized H_2O_2 sterilization, filling and capping are finished in clean seamless chamber.
- Online aseptic air drying monitoring.
- Hundred grade flow hoop device makes sure the air in the machine clean.
- Simplified bottle neck positioning technology by mold plate opening and closing, which is applicable for filling various bottles with same bottle neck but different in volume and shape. Thus, the machine is in a quality of high capability, quick changeover time and high production efficiency.
- Servo driven magnetic cap screwing technology with simple structure, high stability, long service life and securing the cap screwing.
- Machine is made of stainless steel, which can meet food grade requirements.
- Drip proof design for filling heads.
- High efficiency and energy saving.
- Easymaintenance.

* Parameters and functions are subject to change without further notice.

Working Process:

1. Bottle feeding with screw rod
2. Bottles are picked by robot arm and then transported to the bottom
3. The bottles are place upside down and then sterilized by vaporized hydrogen peroxide
4. Dry the bottle
5. Turn the bottle back and fill the bottle with the liquid two times
6. Capping
7. Picked out the filled bottles
8. Output the finished products



YSYGF Automatic Rotary Plastic Bottle Filling and Sealing Machine

YSYGF series machine is capable of working under full-automatic conditions. The machines are applicable to the packaging production of milk, yogurt, milk beverage, fruit juice and so on, the completed full-automatically process is from vacuum negative pressure filling, cap-forming, capping, high-frequency sealing to product outputting.

Applicable Filling material: Liquid: Yogurt, milk, drink, fruit juice and so on. (Viscosity: 10~30 centipoises)
 Applicable packaging material: HDPE/PP/PS/PET bottle; Cap material is Al+plastic laminated film.

Main Technical Data:

Model	YSYGF-24	YSYGF-32	YSYGF-40	YSYGF-48
Filling heads	24	32	40	48
Standard capacity	21000bph (100ml)	28500bph (100ml)	34000bph (100ml)	40000bph (100ml)
Filling volume	100~1000ml	100~1000ml	100~1000ml	100~1000ml
Bottle height:	80mm~280mm	80mm~280mm	80mm~280mm	80mm~280mm
Bottle diameter:	φ 40mm~ φ 85mm	φ 40mm~ φ 85mm	φ 40mm~ φ 85mm	φ 40mm~ φ 85mm
Total power:	14.2KW	14.2KW	18.17KW	19.00KW
Air pressure:	≥0.6MPa	≥0.6MPa	≥0.6MPa	≥0.6MPa
Weight(appr.):	4000Kg	5000Kg	6000Kg	7000Kg
Power supply(optional):	3N-PN-50Hz 380V/220V (3P 5 wires)			

* According to different characteristics of products, the capacity will be different.

Main Configuration:

Pneumatic component:	SMC, FESTO, AirTAC
Sensor:	P+F
Touch screen:	Siemens
PLC:	Siemens
Liquid level inspect sensor:	Omron
Inverter:	Schneider
Central lubrication system:	BIJUR
Warning light:	SCHNEIDER

Optional Function:

1. Class 100 laminar flow hood
2. Bottle rinser, Unscrambler.
3. Sterilization tunnel
4. Capping machine
5. Sleeve labeling machine
6. Pillow-type packaging machine, shrink machine, case erector/case packer/case sealer
7. Conveyors
8. Code printer, ink-jet printing
9. Can be equipped with automatic packaging line

Equipment Structure:

Driving system:

- The main motor is controlled by the inverter, The users can adjust the production speed within its capacity.
- Gear drive system, which can transmit the power to the movement parts.
- Electromagnetism clutch control

Conveyor system:

- Slat conveyor, 5m length, height adjustable
- Engineer plastic star wheel

Filling system:

- Piston filling, high precision filling
- Floating ball switch inspect liquid level
- 316 stainless steel liquid filling valve
- The feeding valve is single seat valve

High frequency sealing system:

- High frequency generator produce high frequency current
- The cooling device is composed of booster pump and pipes, which is used to cool the electrical board and controlling cabinet.

Central lubrication system:

- Lubrication oil supply center
- Oil tube, oil mouth and allot joint
- Oil pressure automatic alarm device
- Lubricate automatically to each moving parts

* Parameters and functions are subject to change without further notice.

Some Samples:





YLP Bottle Unscrambler

YLP bottle unscrambler is composed of carrying bottle part, bottle arrangement turntable, main bottle arrangement part, electronic control unit and pneumatic device.

A large amount of disorganized bottles is involved in bottle arrangement turntable, which is sent by carrying bottle part, and then conveyed to bottle arrangement part by the belt so as to the bottles can be stood and transferred to the user's conveyor in an organized way.

Bottle storage part can store a great number of bottles and is able to convey the bottles to bottle arrangement turntable. The speed of conveyor line can be adjusted by potentiometer of electrical box. Motor on and off can be controlled by photo electricity, which is external set on the cover of turntable.

Applicable bottle: The bottle mouth and membrane line should be flat. The deviation of the bottle mouth should be less than $\pm 0.25\text{mm}$. The deviation of the bottle height should be less than $\pm 0.2\text{mm}$.

Applicable bottle material: HDPE/PP/PS etc.

Main Technical Data:

Standard capacity:	Depending on the bottle size
Qualification rate:	$\geq 99.5\%$
Bottle height range:	80~280mm
Bottle dia range:	$\phi 40 \sim \phi 85\text{mm}$
Total power:	3.16Kw
Running power:	60%-80%
Air pressure:	$\geq 0.6\text{MPa}$
Air consumption:	$\geq 0.8\text{m}^3/\text{min}$
Power supply(optional):	3+N+PE 50Hz 380/220V $\pm 10\%$
Carrying bottle part size:	L2100xW1100xH1600mm
Machine dimension:	L2500xW2200xH1600mm
Machine weight :	800Kg

* According to different characteristics of products, the capacity will be different.

Main Configuration:

Reducer:	Meiwa
All low voltage electrical parts:	Schneider
Warning light ,button and switch:	Siemens APT
Touch screen:	Siemens/YOUNGSUN
PLC:	Siemens
Inverter:	Schneider

* Parameters and functions are subject to change without further notice.

Equipment Structure:

Main working process:

- Automatically feeding the bottles
- Bottle arranging
- Pneumatic output the bottles

Main frame:

- High quality stainless steel plate, stanchion, supporting unit, which is in a quality of good mechanical intensity.
- The machine adopts enclosed design

Driven system of the turntable:

- The main motor is controlled by frequency converter and the speed can be adjusted within production capacity
- Gear driven system can transfer the power to the running part

Pneumatic system:

- Low pressure protector, which guarantee the air pressure of the system
- Integrated electromagnetic valve

Electrical control system:

- High performance PLC, display various controlling information, status inspection information and warning information
- Humanized operation interface and display warning information timely
- Emergency stop button is set in necessary parts





YXG Series Automatic Rotary capping machine

YXG Series automatic rotary capping machine has been designed with high quality and well known for their reputation of reliability and durability. The rotary capping machine integrates bottle inlet, cap sort, cap feed, capping, bottle outlet together. Well suitable for diversified caps, also very friendly applicable for anti-theft caps. Caps are grasped and positioned well, harmless to caps during the machine running. Magnetic cap screwing technology, continuous adjustable magnetic torque of capping head and ensuring fastness of the cap.

Applicable bottle: PET/PP/Glass round or square bottle
 Applicable cap: Plastic screw cap/ Pressure cap

Main Technical Data:

Model	YXG-10	YXG-12	YXG-18	YXG-24
Screwing heads	10	12	18	24
Standard capacity	15000bph (500ml)	20000bph (500ml)	30000bph (500ml)	40000bph (500ml)
Bottle volume range	220-1250ml	220-1250ml	220-1250ml	220-1250ml
Bottle height range	150-320mm	150-320mm	150-320mm	150-320mm
Bottle diameter rang	φ 45- φ 95mm	φ 45- φ 95mm	φ 45- φ 95mm	φ 45- φ 95mm
Total power	2.2KW	2.2KW	4.0KW	6.0KW
Air pressure	0.5-0.7Mpa	0.5-0.7Mpa	0.5-0.7Mpa	0.5-0.7Mpa
Air consumption	0.2-0.3m3/h	0.2-0.3m3/h	0.2-0.3m3/h	0.2-0.3m3/h
Weight(appr.)	3000Kg	3000Kg	5000Kg	6000Kg
Power supply(optional)	3N-PN-50Hz 380V/220V (3P 5 wires)			

* According to different characteristics of products, the capacity will be different.

Main Configuration:

Main motor:	Germany Siemens
Cap lifting motor:	China Meiwa
Touch screen:	Siemens / YOUNGSUN
Cylinder:	SMC / FESTO
Sensor:	P+F
Inverter:	Schneider
Machine frame:	304 stainless steel

Optional Function:

1. Heraeus sterilization module for the cap
2. Filling machine

Machine Features:

- Suitable for PET/PP/Glass bottle capping
- Siemens PLC control marks machine in an easy and stable operation.
- 304 stainless steel machine framework, meet food industry requirements.
- Can be equipped with the Heraeus sterilization module for the cap.
- Automatic detection for the outlet products and Reject non-conform product.
- High efficiency and energy saving.
- Easy maintenance.

Working Process:

1. Caps are oriented and supplied to the cap grasping area
2. Capping heads graspe caps and send to capping area
3. Doing capping work
4. Bottles with cap are outlet by conveyor

* Parameters and functions are subject to change without further notice.





YOUNGSUN Cap Maker

YOUNGSUN cap maker is an important part of rotary plastic bottle filling and sealing machine, It is between filling system and sealing system. It includes two systems, cap (lid) making system and aluminum cap conveyor adding cap system and includes following procedures: automatic film feeding device, driving device, automatic film collecting device, split lid device, automatic waste film recycling device etc.

The splitting module cuts the film into three or four caps, and then the caps are slid into the end of the slideway to be awaiting to be taken by the mouth of the bottle.

Main Technical Data:

Cap film material:	Al+plastic laminated film
Cap film dimension:	According to the bottle mouth
Cap film thickness:	0.10 mm -0.12mm
Standard capacity:	≤25000bph for three Splitting Module ≤40000bph for four Splitting Module
Bottle height:	80mm~280mm
Bottle diameter:	φ40mm~φ85mm
Capping motor power:	1kW
Outer dimensions :	L900XW900XH2500

* According to different characteristics of products, the capacity will be different.

Equipment Structure:

Cap (lid) making system:

- Split type cap making device
- Punch film driving device
- Make cap module
- Install film manually
- Automatically collect film device
- Blowing system

Aluminum cap conveyor adding cap system:

- The aluminum cap slideway feed the cap
- Automatic cap adding device puts the aluminum cap on the bottle mouth

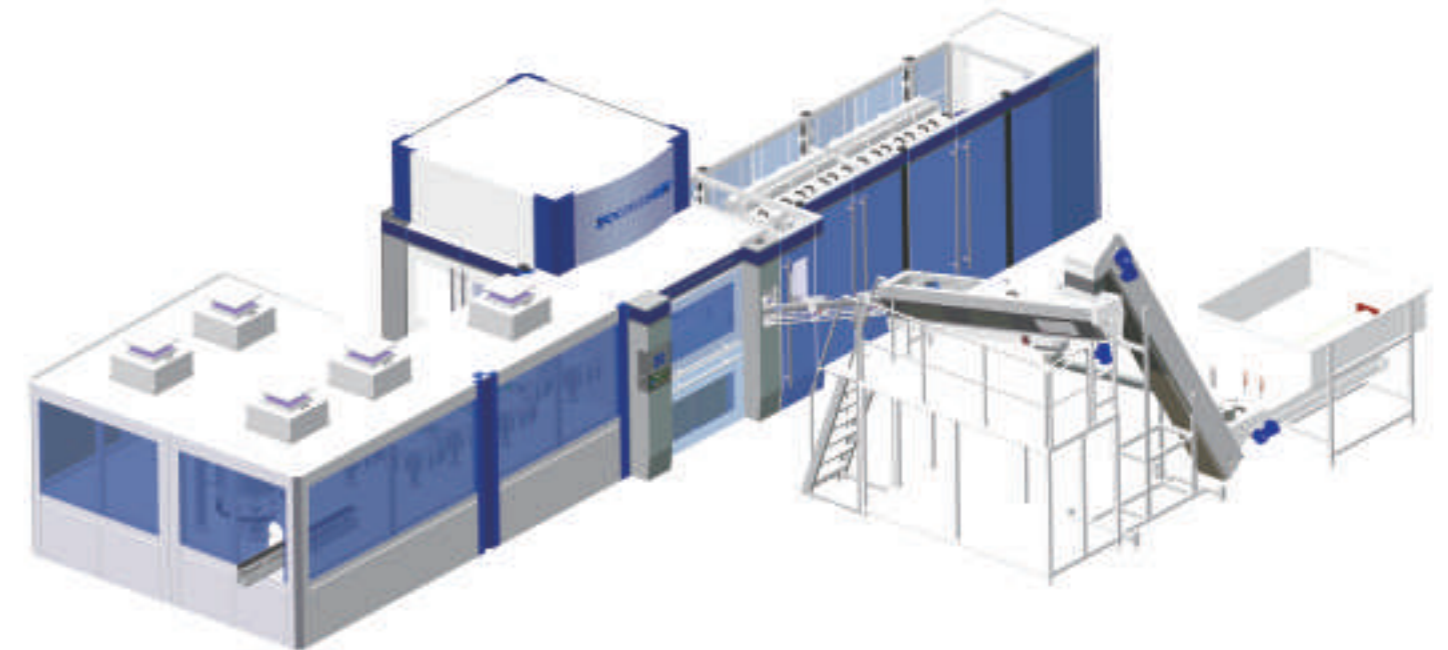

CGX722 Blowing, Filling and Capping Combiblock

CGX722 blowing, filling and capping machine integrates the blowing system, filling system and capping system. The transmission, empty bottle handing and storage processes are reduced. It has a wide application in beverage industry and packaging of liquid products as juice, milk drink, water etc.

Main Technical Data:

Power supply:	380V/50Hz	Filling products:	Liquid products
Production capacity:	36000bp/h	Filling heads:	72
Screwing heads:	24	Air consumption:	0.4m ³ /h
Air pressure:	0.7Mpa	Applicable bottle:	PET round or square bottle
Max. Bottle body diameter:	75mm	Max.Height:	260mm
Max.Mouth diameter:	38mm	Max.Perform height:	140mm

* According to different characteristics of products, the capacity will be different.

Machine Features:

Blowing, filling and capping are integrated in one machine, Bottle neck handling in all process. Ion air blowing dust-suction system and hydrogen peroxide sterilization are optional. Siemens PLC control marks machine in an easy and stable operation. Sanitary and washable capping system, the intensive UV sterilization and aseptic water rinsing sterilization for cap feeding are optional. High efficiency, low energy, easy maintenance.





YSJ Serial Spray Type Pasteurization Tunnel

YSJ Series spray type pasteurization and cooling tunnel performed food sterilization on normal pressure, its temperature is controlled 2~3℃ lower than water boiling point, the actual temperature is often decided by food sterilizing technical requirement and location(when air pressure lower than boiling point, temperature is low, so maximum sterilizing temperature is low too.)

It adopts sterilization method, the principle is limited in a certain temperature range 85℃-90℃. If the temperature is high enough, the bacteria will die. Different bacteria have different optimum growth temperature, heat resistance, and cold capacity.

Applicable product: high temperature instant sterilization of liquid materials such as milk, soy milk, food, fruit juice and so on.

Main Technical Data:

Model	YSJ-5	YSJ-6	YSJ-7	YSJ-8
Qty of sections	5	6	7	8
Each section size	2580x2800mm	2580x2800mm	2580x2800mm	2580x2800mm
Power of pasteurizater:	16.87KW	19.87KW	22.87KW	25.87KW
Match Qty of cooler:	1 section	1 section	2 sections	2 sections
Power of Cooler	5.87KW	5.87KW	7.87KW	7.87KW
Water pressure:	≥0.2MPa	≥0.2MPa	≥0.2MPa	≥0.2MPa
Qty of pump:	6	7	8	9
Air pressure:	≥0.6MPa	≥0.6MPa	≥0.6MPa	≥0.6MPa
Weight(appr.):	4000Kg	5000Kg	6000Kg	7000Kg
Heat consumption:	90000 kcal / hour	112500 kcal / hour	135000 kcal / hour	157500 kcal / hour
Machine size(L x W x H):	14.4×2.28×1.8m	16.8×2.28×1.8m	19.2×2.28×1.8m	21.6×2.28×1.8m
Power supply(optional):	3N-PN-50Hz 380V/220V (3P 5 wires)			

* According to different characteristics of products, the capacity will be different.

Main Configuration:

PLC: Siemens
 Electric pump: Denmark "GRUNDFOS"
 Steam valve: German "GEMU"
 Thermolator: "MEIWE" or "OMRON"(option)
 Electrical components: France "Schneider"
 Plate heat exchanger: Shanghai "Jiangxing"
 Chain conveyor: Italian "Regina"

Steam pressure: 0.5~0.8MPa
 Bottle feed conveyor height: 1000±50mm
 Cable requests: adopts 3x6mm²+1 x 4mm² cable, with good and reliable grounding
 Water requests: Cleaning water should be conformed to national health standard for drinking
 Temperature requests: Cooling tower water :20℃-25℃
 Product feeding :30℃-45℃
 Out put :38℃-42℃

Diameter of water pipe: 103mm
 Chain conveyor: Polypropylene mesh, suitable for use in 110℃

Machine Features:

- Frame Material; AISI304 stainless steel
- Be configured according to the insulation layer
- Heat exchanger; Tube steam type
- Polypropylene mesh conveyor belt, can be used for 110℃;
- Water tank are all stainless steel;
- Spary pipe are all stainless steel;
- Stainless steel plate cover and side cover, easy for disassembly, cleaning and maintenance inspection;
- Easy to transport, easy to install on site, without welding
- The temperature display, platinum thermocouple type PT100, pressure gauges, temperature controller
- HMI adjust the temperature

* Parameters and functions are subject to change without further notice.





YSXB Series Automatic Rotary Preformed Cup Filling and Sealing Machine

YSXB Series automatic rotary preformed cup filling and sealing machine is applicable to pack the products like yogurt ,milk,mineral water, beverage , ice cream, seasoning and so on.The process is from cup separating, sup falling,quantitive filling, suck cap film,sealing,and product conveying.The choice of the machine model and number of filling heads depends on the factors like required output, size and type of packaging and requirements for additional equipment.

The machine can provide a lot of solutions for the below field:suitable for both traditional and innovative packaging designs, quick change-over to alternative packaging, different ways of container closing.

Applicable Filling material:Liquid:yogurt ,milk,mineral water, beverage , ice cream, seasoning and so on
Cap film material:Al+plastic laminated film;paper+plastic laminated film.

Pre-cut lid or film roll.

Preformed cup type: Paper cup,Plastic cup,Alu.cup etc.

Main Technical Data:

Model	YSXB-2500	YSXB-3500	YSXB-5000
Cups per lane	2	3	4
Standard capacity	2500 cups/h (100g)	3500 cups/h (100g)	5000 cups/h (100g)
Filling volume	90g-200g	90g-200g	90g-200g
Cup mouth specifications	φ 50- φ 80mm (can be customized)		
Cup height	25~140mm	25~140mm	25~140mm
Total power	3.5KW	3.5KW	4.5KW
Air pressure	≥0.6MPa	≥0.6MPa	
Machine weight(appr.)	2000Kg	2500Kg	3000Kg
Power supply (optional)	3N-PN-50Hz 380V/220V (3P 5 wires)		

* According to different characteristics of products, the capacity will be different.

Main Configuration:

Servo motor	Siemens
Cylinder:	SMC/ CAMOZZI
Reducer box:	SEW
Sensor:	P+F
Touch screen:	Siemens/YOUNGSUN
PLC:	Siemens
Position inspecting sensor	P+F
Warning light	Schneider
Relay	Schneider
Liquid level inspecting	E+H
Pneumatic components	AirTAC/SMC/Festo

* Parameters and functions are subject to change without further notice.

Machine Features:

1. Both pre-cut lid and film roll can be equipped with high efficiency UV sterilization devices to improve the hygiene level of product.
2. Rotary step design, saving the space and reducing the operation cost.
3. Due to the quick changeover design, shorten changeover time for different cup diameters.
4. Roll film sealing devices will be optional.
5. Online fruit grain mixing system, can realize multipurpose production.
6. The adoption of filling system is separate, which is convenient for maintenance.
7. Realize pressure cleaning, the cleaning circuit without dead angle.

Machine Structure:

- Conveyor system
- Cup sterilization system (optional)
- Adding film system
- Sealing system
- Cup output system
- CIP cleaning nozzle
- Electric controlling system
- Cap falling system
- Filling system
- Cap sterilization system (optional)
- Waste margin collecting system
- Coding system
- Class 100 laminar flow hood
- Dynamic fruit grain mixture filling system

Some Samples:





YSXZL Serial Pouch Filling and Capping Machine

YSXZL Series Pouch Filling and Capping Machine is capable of working under full-automatic conditions. The process is from sachet loading, vacuum, fixed-position filling, nitrogen gas filling (optional), cleaning for spout, cap feeding and inserting, cap-screwing, pouch discharging and liquid controlling.

Applicable Filling material: Liquid or semi-liquid (for example: fresh milk, yogurt beverage, juice, pure water, beverage, sauce, low consistency jam, oil etc)
 Applicable packaging material: OPP/AL/PE, PET/VMPET etc.

Main Technical Data:

Model	YSXZL-1500	YSXZL-3000	YSXZL-5000
Filling heads	1	3	5
Standard capacity	1500bags/hour	3000bags/hour	5000bags/hour
Filling volume	120 - 1000ml	120- 1000ml	120- 1000ml
Total power:	4KW	5KW	6 KW
Air pressure:	≥0.6MPa	≥0.6MPa	≥0.6MPa
Air consumption:	≥0.8m³/min	≥0.8m³/min	≥0.8m³/min
Outer dimensions(appr.)	3.9×2.7×2.1m(L×W×H)	3.7×2.3×2.8m(L×W×H)	4.6×4.8×3.2m(L×W×H)
Weight(appr.):	1400Kg	2000Kg	2500Kg
Power supply:	3N-PN-50Hz 380V/220V (3P 5 wires)		

* According to different characteristics of products, the capacity will be different.

Main Configuration:

Main electrical components:
 Cylinder: Siemens
 Driver: SMC/ Festo
 Sensor: SEW
 P+F
 Touch screen: Siemens
 PLC: Siemens
 Inverter: Schneider

Optional Function:

1. Class 100 laminar flow hood
2. Code printer, ink-jet printing.
3. Heraeus sterilizing module(for cap and spout)
4. Fruit particles adding module

Equipment Structure:

Turntable and traction system:

- Drive by inverter
- Turntable
- Mechanical drive system
- Framework and safety guard

Bagging system:

- Sachet magazine
- Bagging system
- Automatic sachet feeding system
- Detection sensor for bagging

Filling system:

- Pressure & capacity quantitative system
- Cleaning system
- Filling system
- CIP cleaning interface

Capping system:

- Sensor detection
- Cap sorting device
- Cap magazine
- Cap putting sideway

Screw cap system:

- Cap swivel head
- Drive system to control up-and-down motion of swivel head

CIP cleaning system, material cylinder body and liquid level control system:

- Pneumatic conversion valve
- Stainless steel material tank
- CIP cleaning accessories

Control system:

- PLC control
- Trouble alarm with warning information
- HMI system (touch screen)
- Safety protection

* Parameters and functions are subject to change without further notice.

Some Samples:



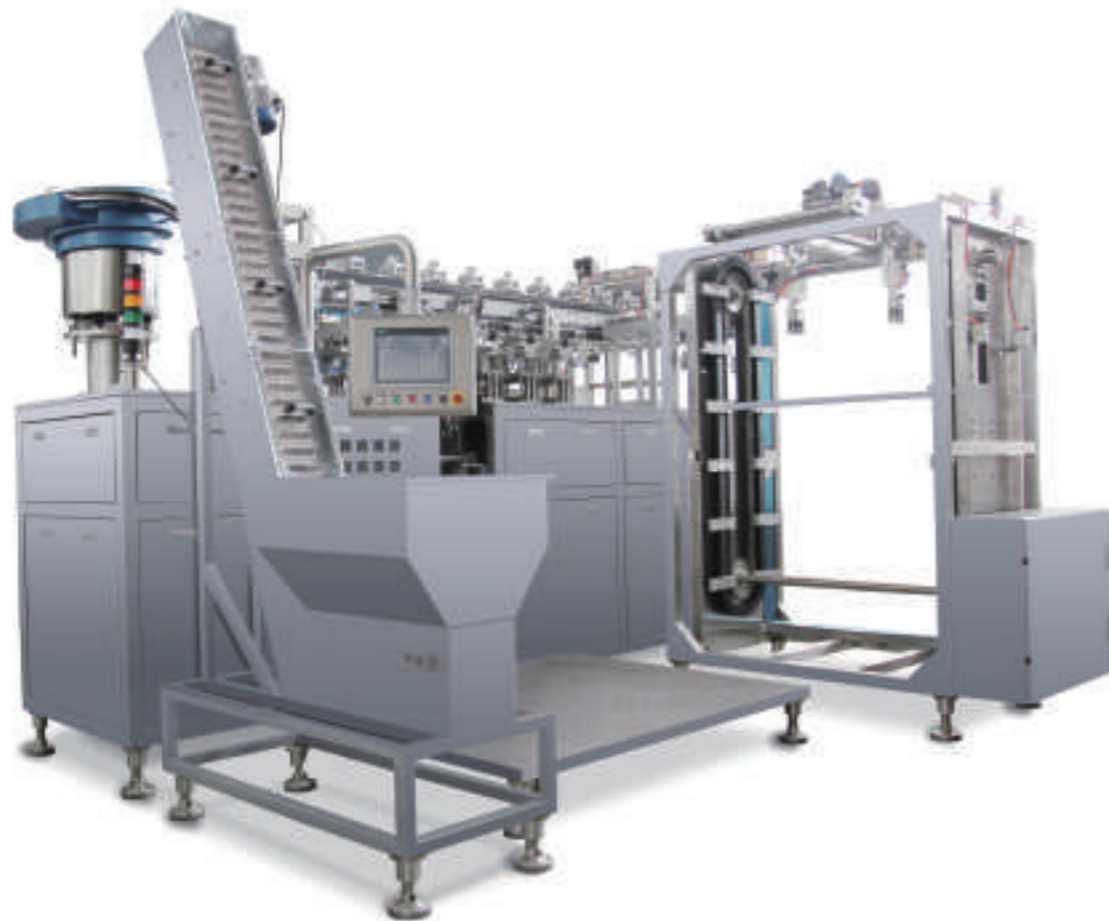

YOUNGSUN Spout Inserter

YOUNGSUN spout inserter has been designed with high quality and well known for their reputation of reliability and durability.

YOUNGSUN has years of experience in manufacturing spout inserter. The high quality of all material and strict technical standard for all mechanical and electric components, with high efficiency, precise assembling and rigorous testing procedures, lead to high performance, safe and durable products.

Spout inserter is designed for inserting and sealing spouts on the top center of stand up pouch. It has wide application in food, beverage and daily chemical industry.

Main Technical Data:

Pouch type:	Stand up pouch
Max.Speed:	43 pcs/min
Working efficiency:	≥90%(Material, packing material and equipment maintenance will affect the efficiency and yield)
Qualification rate of products:	≥99.5%
Power:	13KW
Air pressure:	0.6~0.8MPa
Power supply:	380V/220V (3P 4Wire)(Can be customized)
Equipment dimensions (about):	Depends on final design and factory layout
Weight (about):	4500Kg

* According to different characteristics of products, the capacity will be different.

Main Configuration:

Electrical components	Brand	Country
Cylinder	Festo	Germany
Main drive	Schneider	French
Speed reducer	Sew	Germany
Main electrical parts	Siemens	Germany
PLC	Siemens	Germany
Sensor	P+F	Germany
Touch screen	Siemens	Germany

* Parameters and functions are subject to change without further notice.

Machine Features:

1. With rail feeder, which means the pouches will be pushed and output on the rails. Then, the rails with pouches will be taken manually for the feeding of filling machine. All components are made of carbon steel or stainless steel, which can meet hygienic and quality requirements of food and pharmaceutical industry and environmental standard.
2. Automatically detects faults, show the fault, sound an alarm and shut down the machine.
3. Easy to operate, precise control, stable operation and long service life.
4. High efficiency and energy saving.
5. Easy maintenance.

Equipment Structure:

Machine structure:

- Spout sorter
- Inserting and sealing system
- Pouch feeding system
- Output system

Spout sorter system:

- Chute
- Lead rail
- Vibrating disks

Pouch feeding system:

- Pouch storage system
- Pneumatic sucker

Inserting and sealing system:

- Pouch inserting system
- Clamping system
- Heat sealing system

Output system:

- Pouches (with spouts) output
- Collection system

Secondary Packaging System

To serve as the manufacturer of advanced packaging system and engage in providing the best packaging solution for customer. YOUNGSUN secondary packaging system covers the beverage, food, household & personal care products and other industries. The packaging system will be designed based on customers' different requirements of bottle, can, film pack and box.

Based on the features of beverage enterprise production, the packaging and intelligent storage system will cover the whole processes including forming, filling, sealing, labeling, coding, strapping, palletizing, pallet stretch wrapping etc.

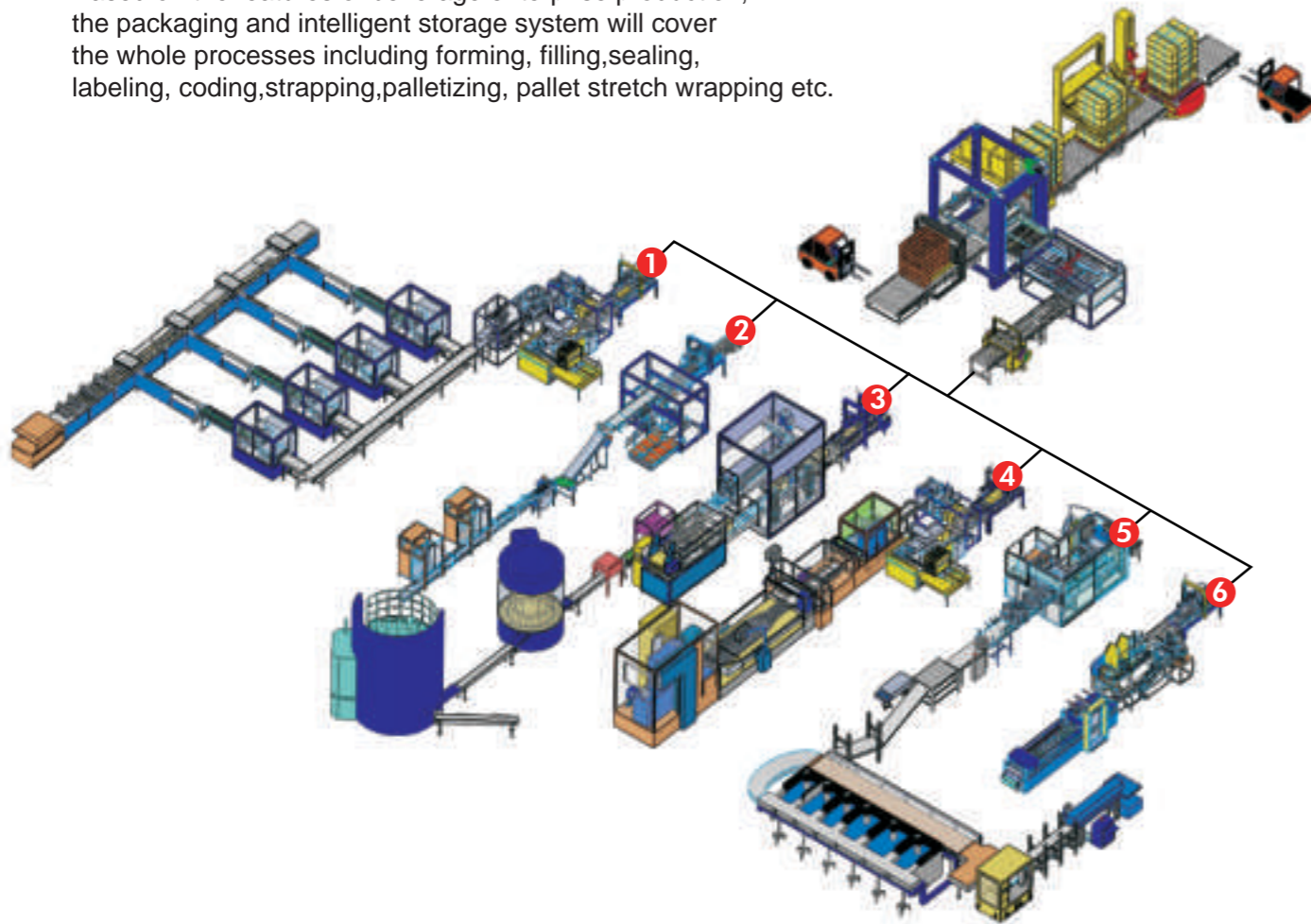

1. Bakery food pillow packaging and cartoning packaging line.
2. Granular product bagging packaging line
3. **Liquid filling packaging line**
4. Quantitative powder packaging line
5. Powder and Solid products in cans packaging line
6. Vacuum food packaging line.

Service and Support

Customer Service:

YOUNGSUN will work with business partners in various fields to provide planning, design, configuration, installation, implementation and upgrading of automated data acquisition schemes for the users.

YOUNGSUN will provide comprehensive and professional services to ensure the successful implementation of packaging machinery equipment.

Technical Support:

YOUNGSUN has professional technical service team, Through the advanced technical means, such as technical maintenance, customer support center, etc., to systematically guarantee the service to be continuity and professionalism, and provide high-quality packaging machinery parts.

- Turnkey project
- Focused site service
- Perfect spare parts supply system
- After-sales service

Training Service:

Considering the requirements of the customers, YOUNGSUN design the training courses to ensure that the staff in customer side fully understand the operation, structure, principle and the maintenance of the machinery equipment.

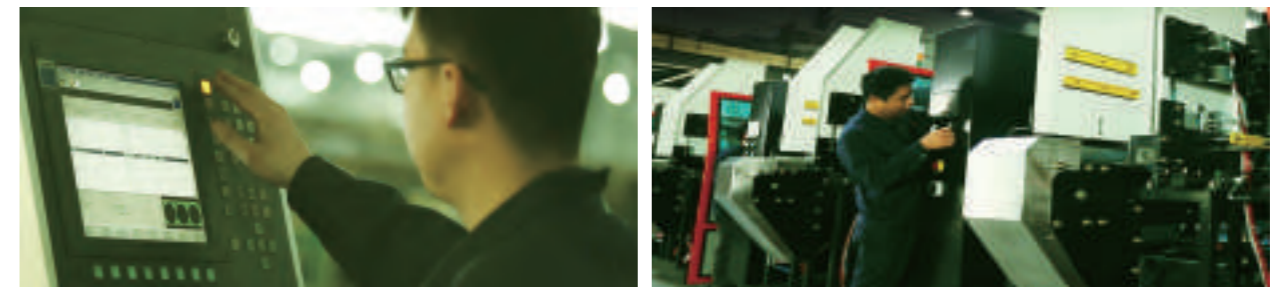



YOUNGSUN[®]

Hangzhou Youngsun Intelligent Equipment Co., Ltd.

Add: No.2, Xiyuan 7 RD , West Lake Science & Technology Development Area,
Hangzhou, China 310030

Tel: 0086-571-28117789

Fax: 0086-571-28066599

www.youngsunpack.com

michael@youngsunpack.com



AAA